



**HARO**<sup>®</sup>  
Quality Flooring

Laminate Floor TRITTY 200 Aqua

The durable Premium Laminate Floor.  
Also suitable for damp areas.

**NEW**





# Laminate Floor TRITTY 200 Aqua

---

*The Tough One – even more durable and with improved moisture protection*

The HARO Laminate Floors are characterised by their authentic wood look, durability and easy installation. With Silent CT they are among the quietest laminate floors in the world – room sound is reduced by an incredible 60%.

Naturally, these properties also apply to the floors of the new TRITTY 200 Aqua Series. They meet the requirements of level of use 33 and are therefore suitable for all high-traffic residential and commercial areas. They have an increased moisture protection and are particularly hard-wearing. This makes it the ideal laminate floor for hallways, kitchens, living rooms and even bathrooms.

All styles are available in our popular Plank-1-Strip format, as well as in the extra-long and extra-wide Gran Via 4V format. Both have bevelled edges on all four sides. In addition, all HARO Laminate Floors are particularly easy to clean and dirt-repellent.

---



[www.blauer-engel.de/uz176](http://www.blauer-engel.de/uz176)





HARO TRITTY 200 Aqua  
Gran Via 4V  
**OAK SICILIA NATURE**  
authentic matt  
(wood reproduction)





HARO TRITTY 200 Aqua  
Gran Via 4V  
**OAK VENETO SAND**  
authentic matt  
(wood reproduction)

Soft natural tones in the look of noble oak create a new level of comfort in bathrooms, kitchens and hallways.



HARO TRITTY 200 Aqua  
Gran Via 4V  
**OAK SICILIA PURO**  
authentic matt  
(wood reproduction)





HARO TRITTY 200 Aqua  
Plank 1-Strip 4V  
**OAK SICILIA PURO**  
authentic matt  
(wood reproduction)





HARO TRITTY 200 Aqua  
Gran Via 4V  
OAK VENETO MOCCA  
authentic matt  
(wood reproduction)

The right laminate floor turns rooms into hard-wearing all-round carefree rooms.



HARO TRITTY 200 Aqua  
Plank 1-Strip 4V  
OAK VENETO HONEY  
authentic matt  
(wood reproduction)



# Range Overview



Plank 1-Strip 4V  
**OAK SICILIA WHITE\***  
authentic matt  
ID no. 537 368



Gran Via 4V  
**OAK SICILIA WHITE\***  
authentic matt  
ID no. 537 374



Plank 1-Strip 4V  
**OAK VENETO SAND\***  
authentic matt  
ID no. 537 369



Gran Via 4V  
**OAK VENETO SAND\***  
authentic matt  
ID no. 537 375



Plank 1-Strip 4V  
**OAK SICILIA PURO\***  
authentic matt  
ID no. 537 370



Gran Via 4V  
**OAK SICILIA PURO\***  
authentic matt  
ID no. 537 376



Plank 1-Strip 4V  
**OAK VENETO MOCCA\***  
authentic matt  
ID no. 537 373



Gran Via 4V  
**OAK VENETO MOCCA\***  
authentic matt  
ID no. 537 379



Plank 1-Strip 4V  
**OAK SICILIA NATURE\***  
authentic matt  
ID no. 537 371



Gran Via 4V  
**OAK SICILIA NATURE\***  
authentic matt  
ID no. 537 377



Plank 1-Strip 4V  
**OAK VENETO HONEY\***  
authentic matt  
ID no. 537 372



Gran Via 4V  
**OAK VENETO HONEY\***  
authentic matt  
ID no. 537 378

\*Wood reproduction



# Technical data

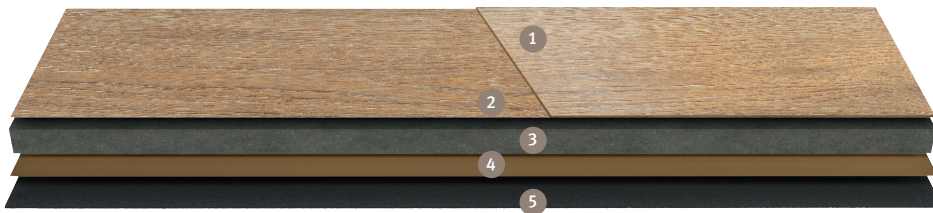

**THE NEW TRITTY 200 AQUA SERIES OFFERS ADDITIONAL SECURITY.**  
 Due to the moisture-control aquaReject coreboard, the floor is optimally protected against moisture and also approved for installation in damp rooms\*  
 And suitable for glue-down installation in accordance with A0. Thanks to the high utilisation class 23/33, the floor is also ideally suitable for areas subject to particularly heavy wear, such as the hallway or the kitchen.

\* Damp rooms are surfaces subject to direct usage in which water and cleaning water is not very frequently used, such as domestic bathrooms for example. It is not suitable for installation in wet areas such as showers or saunas. Please note that splashing water and puddles on the surface must be removed immediately.

1. Overlay with special impregnation (durable protective layer)
2. Decorative laminate, specially impregnated
3. Special moisture-control aquaReject coreboard
4. Balancing laminate
5. Optionally available with integrated Silent Pro luxury insulation layer or with Silent CT technology (suitable for use with underfloor heating)

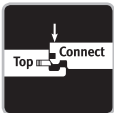

HARO TRITTY 200 Aqua	Dimensions	Level of use	Abrasion class	Warranty	Impact class	Antistatic class
Standard	8 x 193 x 1282 mm	23/33	AC6	25 years in residential applications 10 years in commercial applications	IC3***	ASF2
Gran Via 4V	8 x 243 x 2200 mm	23/33	AC6	25 years in residential applications 10 years in commercial applications		
Silent Pro	2 mm thicker No clearance for damp rooms	Room sound improvement: approx. 30 %**, Footfall sound reduction: 18 dB				
Silent CT	2 mm thicker No clearance for damp rooms	Room sound improvement: ca. 60 %**, Footfall sound reduction: 14 dB				

\* For residential applications with high traffic and commercial applications with medium traffic  
 \*\*Measurement of the reflected footfall EPLF WD 021029-5 "Impact hammer" / IHD work standard 438 "Walking on"  
 \*\*\* Shows how robust a floor reacts when pressed or subjected to impact stress.  
 With IC3 the floor is in line with the highest requirements.



[www.blauer-engel.de/uz176](http://www.blauer-engel.de/uz176)

**HARO Laminate Floor TRITTY is made of 80% wood and free from PVC and plasticisers**





## FORMATS/DESIGNS

**1. Plank 1-Strip 4V.** The Classic One. Particularly popular because of its spacious visual impact, emphasised by the bevelled edges on four sides.  
Dimensions: 193 x 1282 mm  
(7 19/32" x 50 15/32")

**2. Gran Via 4V.** The Gigantic One. Extraordinary appearance and distinctive plank character by bevelled edges on four sides.  
Dimensions: 243 x 2200 mm  
(9 9/16" x 86 5/8")

## SURFACE



### AUTHENTIC MATT

Almost indistinguishable from real wood. Texture and style match perfectly. The surface has a natural oil character.



### BEVELLED EDGES ON THE LONG AND SHORT SIDES

The edges are bevelled on both sides and ends – for an even more vivid impression. Experts call this "long and short side beveling".



## COMFORTABLY EASY TO MAINTAIN

With a Laminate Floor you can reduce your maintenance efforts to a minimum. The durable surface is dirt-resistant and can be cleaned without hassle. Occasional damp wiping is sufficient. This way, you will be able to enjoy your floor for many years.



**clean & green®**  
Quick, easy and natural maintenance of all floors



# Insulation underlays

## THE WORLD'S QUIETEST LAMINATE FLOOR



## HARO TRITTY SILENT CT

Forget annoying stomping, heel clacking and other noises! Silent CT reduces room sound by a sensational 60% compared to standard laminate floors with insulation layer. This is the result of HARO's ComforTec innovation for a full glue-down installation with the subfloor. The result: You can walk with the pleasant acoustic of a fully glued-down floor.

- 60% quieter
- Can be installed without tools thanks to TopConnect
- Suitable for use with underfloor heating
- Warranty up to 25 years

For more information, see: [www.haro.com/info/youtube/](http://www.haro.com/info/youtube/)



## INSULATION LAYER



Especially recommended:  
The factory-laminated insulation layer Silent Pro

- Excellent insulation against footfall and room sound
- The "forest floor effect" is easy on joints and back
- Insulation and installation in a single step
- Suitable for installation over underfloor heating
- Easy and clean to cut
- Environmentally safe disposal of cuttings in domestic waste

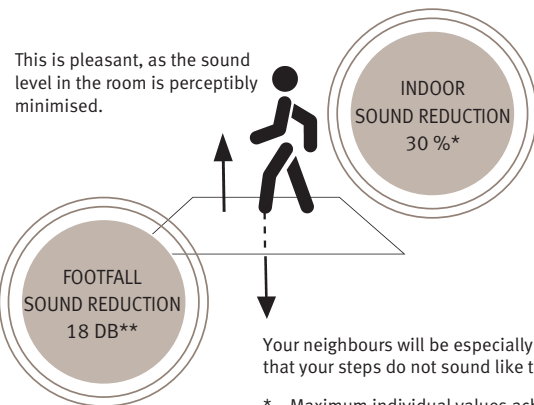

\* Maximum individual values achieved in accordance with the EPLF Impact Hammer test (compared to reference floor)

\*\* In accordance with DIN 140-8



# Skirtings



## **SKIRTINGS – WITH SYSTEM**

Whether matching the floor or contrasting – our range of skirtings provides the perfect finishing touch for every taste, of course also in waterproof variants. For more information about the sheer endless design possibilities contact your HARO dealer.



## **MOULDINGS – STYLISH TRANSITIONS FROM DISTINCTIVE TO SUBTLE**

When installing different floors, a matching transition is an important factor, both visually and haptically. For this purpose we offer metal mouldings or HDF-Easy mouldings matching the floor in colour.



# The Company

---



Company management in  
the fourth and fifth generations:  
Peter Hamberger and  
Dr. Peter M. Hamberger

With a match factory, a sawmill and a brickyard, Franz Paul Hamberger 150 years ago laid the foundation for what is today the globally acting family-run company Hamberger Industrierwerke. Tradition and innovation, regional ties and global success, as well as reliability and flexibility are factors that have always determined the entrepreneurial acting of our company. Even today, the popular laminate and parquet floors from the HARO brand are still being produced at the company's headquarters in Stephanskirchen. Our quality products are Made in Germany. This way we can guarantee the highest possible level of sustainability, among other things because of our certified manufacturing processes. For the protection of our environment and a healthy home.







# Product variety from HARO

In its diversity, wood is a fascinating material. We stand by our passion for wood and use its natural appeal, powerful ambience and diverse properties as the basis for stylish living with our products for the home.



## HARO PARQUET

Our Parquet Floors are made exclusively of the highest quality wood. With a HARO Parquet, you can lastingly enhance your rooms and enjoy the highest level of living comfort for many years to come.



## DISANO by HARO

DISANO is not only the perfect solution for modern and vibrant living. DISANO also creates a 100% healthy living environment and is produced without the use of any plasticisers or other environmentally hazardous substances.

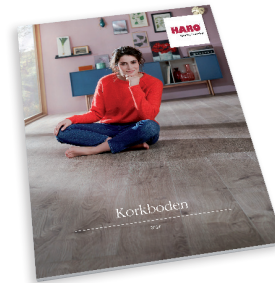

## CORK FLOORS

For decades, cork flooring was found almost exclusively in children's rooms and day care centres. This was owed to its underfoot warmth and soft surface. We have made it attractive as a real alternative for stylish living.



## PARKETTMANUFAKTUR by HARO

What emerges here from masterful craftsmanship are floors that are unsurpassed when it comes to noblesse and uniqueness. With real workmanship, the most precious woods are processed into top class parquet floors.



## CELENIO by HARO

Our passion for wood combined with our eagerness to find extraordinary solutions have led to the unique innovation CELENIO: the combination of the optics of stone with the warmth of wood.



## INTERIOR

With HARO Interior you can also use the natural charisma of precious wood for wall design and panelling on the sides of the stairs. As a perfect eye-catcher, you will also find the "HARO Table" here.







